



Creed Road, Oundle  
£345,000



A beautifully light, three bedroom detached house presented in good condition, with the added benefit of a garage and a private rear garden. The property has tall ceilings throughout giving a spacious feel to all rooms, the entrance hall and first floor landing. Offering a spacious living room from front to back, a good size kitchen/dining room with French doors to the rear garden and a guest w.c. on the ground floor. On the first floor, the principal bedroom has built-in wardrobes and an en-suite shower room, and there are two further good sized bedrooms and the family bathroom.

Externally the rear garden has plenty of room for entertaining and relaxing, with the added benefit of a side gate leading to a single garage.

An internal viewing of this neutrally styled and well maintained family home will not disappoint.

Situated off Glaphorn Road, approximately 1 mile from Oundle marketplace, Creed Road is within close proximity to the Primary School and the doctors surgery.

Tenure: Freehold  
All Mains Services Are Connected  
Gas Central Heating  
Solar Panel Owned  
Council Tax: Band D  
Management Fees Apply: £200pa for 2023/24





# Creed Road, Oundle

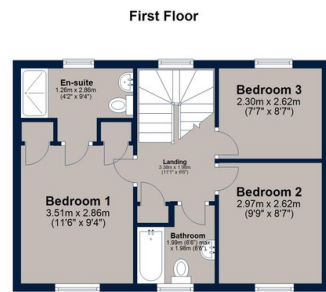

Total area: approx. 98.6 sq. metres (1061.3 sq. feet)  
 Plan is for illustration purposes only and may not be representative of the property. Plan is not to scale. Plan produced by M-Photo  
 Plan produced using PlanUp.



Osprey Oakham  
 4 Burley Road  
 Oakham  
 Rutland LE15 6DH  
 01572 756675  
 oakham@osprey-property.co.uk

Osprey Stamford  
 7 Red Lion Street  
 Stamford  
 Lincolnshire, PE9 1PA  
 01780 769269  
 stamford@osprey-property.co.uk

Osprey Oundle  
 6 Crown Court  
 Market Place  
 Oundle, PE8 4BQ  
 01832 272225  
 oundle@osprey-property.co.uk

Osprey Melton  
 8 Burton Road  
 Melton  
 Leicestershire, LE13 1AE  
 01664 778170  
 melton@osprey-property.co.uk

An immaculately presented three bedroom detached home with garage and private garden. A low maintenance and ready to move into house on a popular residential development.

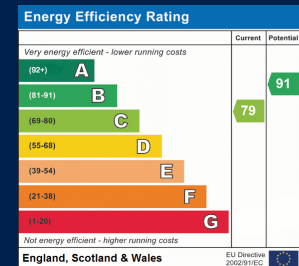

Agents Note: Whilst every care has been taken to prepare these particulars, they are for guidance purposes only. All measurements are approximate, and are for general guidance purposes only and whilst every care has been taken to ensure their accuracy, they should not be relied upon, and potential buyers/tenants are advised to recheck the measurements