



South Road, Oundle
£325,000



This beautifully presented stone property is set over three floors, with the benefit of off-road parking. Discreetly situated off South Road, a short walk to Oundle Marketplace, this home offers versatile accommodation. The current resident uses the top floor room as a large double bedroom, which opens onto the roof terrace; however, this space has previously been used as a living room. Barley House has lots of character, with quarry-tiled flooring in some rooms, beams to ceilings and a vaulted room on the top floor. The kitchen has been replaced in recent years with pale grey Shaker cupboards and wood-effect worktops, with Metro tiled splashbacks. On the ground floor there is a cloakroom, and the first-floor bathroom enjoys a four-piece suite to include a separate shower cubicle.

Offered with no forward chain and with no listing constraints, this delightful property needs to be viewed to be appreciated.

Tenure: Freehold
All Mains Services Are Connected
Gas Central Heating
No Forward Chain





South Road, Oundle, Northamptonshire

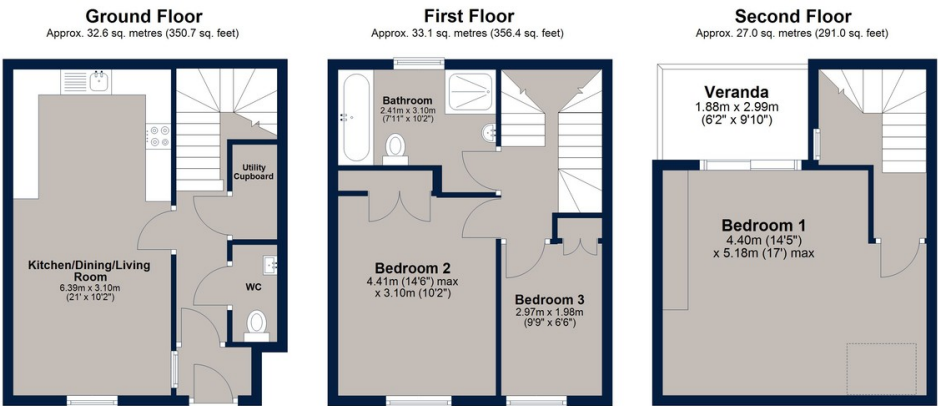

Total area: approx. 92.7 sq. metres (998.1 sq. feet)
This floor plan is for illustrative purposes only and is not to scale. All measurements, doors, windows, rooms and other items are approximate and should not be relied upon for any purpose.
Plan produced using PlanUp.

A handsome stone mews property with parking, roof terrace and flexible accommodation discreetly positioned off South Road, moments away from Oundle marketplace.

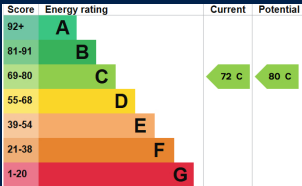

Osprey Oakham
4 Burley Road
Oakham
Rutland LE15 6DH
01572 756675
oakham@osprey-property.co.uk

Osprey Stamford
7 Red Lion Street
Stamford
Lincolnshire, PE9 1PA
01780 769269
stamford@osprey-property.co.uk

Osprey Oundle
6 Crown Court
Market Place
Oundle, PE8 4BQ
01832 272225
oundle@osprey-property.co.uk

Osprey Melton
8 Burton Road
Melton
Leicestershire, LE13 1AE
01664 778170
melton@osprey-property.co.uk



Agents Note: Whilst every care has been taken to prepare these particulars, they are for guidance purposes only. All measurements are approximate, and are for general guidance purposes only and whilst every care has been taken to ensure their accuracy, they should not be relied upon, and potential buyers/tenants are advised to recheck the measurements